

AZUSA SEKKEI
CORPORATE PROFILE



Architectural Design With Passion

Whenever designing a building, we ask ourselves a number of questions:

Have we closely observed and given consideration to the town?

Have we thought through the design, focusing on people and their lives?

Have we looked around the community, imagining its future?

Have we thought outside the box?

Buildings must coexist with local communities and people.

We therefore plan them with aspirations, design them with innovative ideas,

execute the design with meticulous care,

and supervise construction with thoroughness.

We continue to create truly unique designs, expressing our creative passion.

ABOUT AZUSA

More than 70 years since establishment. Azusa has been passionately devoted to architectural design, constantly taking on new challenges.

Company name Azusa Sekkei Co., Ltd.

President,CEO Fumihiko Sugitani

Established October 10, 1946

Capital 90,000,000 Yen

Registrations First Class Architectural Design Office Reg. No. 380 Tokyo Japan / Construction Consultants Reg. No. KEN11-5281 (Urban planning and regional planning area; Port, harbor, and airport area)

Certificates ISO 9001 Quality Management System
ISO 14001 Environmental Management System (excluding overseas offices)

Qualified staffs First-class Architects, 320
1st-Class Structural Design Architect, 17
1st-Class Mechanical & Electrical Design Architect, 15
Professional Engineer, 7
redevelopment Planner, 10
Building Mechanical and Electrical Engineer, 61
Interior Planner, 16

Design achievements for sport and airport facilities

No.1
in Japan

Number of employees

625

Establishment

1946

Architectural firm domestic ranking*

No.3

Overseas bases

5 PLACES

BEIJING / SHENYANG / HO CHI MINH / Ha Noi / YANGON



As of December 1, 2019

*Ranking of architectural firms dedicated to design (fiscal 2018), excluding large group-affiliated design firms

SOLUTIONS Azusa Sekkei's proposal expertise

To pursue our clients' satisfaction, we have created a system to maximize our design and solutions capabilities.

01 Survey / Planning

From the initial stage of launching a project, we examine, survey and analyze based on each of the client's requests, and propose services that will maximize their profit.

- Architectural, urban, area, and other planning
- Environmental impact assessment
- Existing facility surveys, and earthquake-resistance and facility diagnoses
- Survey, analysis and diagnosis relating to building maintenance and management
- Renovation planning
- Project planning
- Land and soil surveys, and analyses
- Assistance with obtaining development permits, applying for building confirmation, and handling other regulatory procedures

02 Consultation

We serve as a consultant to the client at every phase of the architectural project, from the initial planning stages to design, construction supervision, and operation, and strive toward optimization for the entire project, from a perspective different from that of a designer or builder.

- Project management (PM)
- Construction management (CM)
- Facility management (FM)
- PFI consulting

03 Design (basic design and execution design)

Possessing a wealth of experience, we propose a concept that will increase the client's value. We build consensus with the client smoothly and confidently using BIM/3D technology, and achieve an architectural result that is superior in terms of environmental performance, design, safety and economic efficiency.

- Conceptual, structural, facility and interior design
- Landscape design
- Various simulations
- Program development

04 Supervision

We have experts in every field who guide and supervise to ensure understanding of the design concept and an appropriate execution. Due to our close cooperation with the builders, we have a full understanding of the construction progress and thoroughly maintain quality throughout the project.

- Design and supervision
- Construction oversight
- Construction supervision
- Cost management

Strengths: Five business domains

To provide our clients with the highest level of service at any time or place, Azusa Sekkei has built an organization of five domains: transport infrastructure, sports and entertainment, urban development and commercial facilities, health care, and workplaces. We work as cross-departmental teams, beyond boundaries between headquarters, branch offices, departments, and overseas affiliates. Our teams drive Azusa's competitive edge, as we continue to fine-tune our expertise and further increase our brand equity.

	TRANSPORT INFRASTRUCTURE Harnessing the expertise accumulated through designing airports	→ P05	
	SPORTS • ENTERTAINMENT Leading Japan's sports and entertainment culture	→ P07	
	URBAN DEVELOPMENT / COMMERCIAL FACILITIES A leader of urban and architectural innovation	→ P09	
	HEALTHCARE Designing a wide variety of spaces	→ P11	
	WORKPLACE Creating the future of government and office buildings	→ P13	
	LOGISTICS & BASIC INFRASTRUCTURE Build the diversity social demand based on experience and quality	→ P15	

HISTORY Azusa Sekkei's journey

This is the history of Azusa Sekkei's progress as an architectural firm.

*These are conceptual images and may differ from the actual finished product. The plants are shown as they will appear 10 years after completion.
© Taisei Corporation, Azusa Sekkei Co., Ltd. and Kengo Kuma and Associates Joint Venture.

1946	1950	1955	1960	1965	1970	1975	1980	1985	1990	1995	2000	2005	2010	2015	2020	
TRANSPORT INFRASTRUCTURE		Japan Airlines Operation Center (1957)	A boarding bridge was introduced for the first time in Japan.		Fukuoka Airport Terminal 1 Building (1969)	Dai Nippon Distribution Center (1971)	El Salvador International Airport (1975)				Narita International Airport Terminal 2 Passenger Building (1992)	Tokyo International Airport Terminal 1 (1993)	Following an increase in aviation demand, the '90s saw a huge expansion of Azusa's domestic market share for airport terminals.		JR Shin-Tokai Station (2014)	Wattay International Airport (2019)
SPORTS ENTERTAINMENT		Nakano City Auditorium (1954)							Toyama General Sports Center, pool building (1984)	Nagoya Civic General Gymnasium (1987)				Saitama Stadium 2002 (2001)	Shimonoseki Budokan (2011)	New National Stadium Project (scheduled for 2019)
URBAN DEVELOPMENT / COMMERCIAL FACILITIES						We expanded our domains when large-scale public facility construction increased.		Hotel The Italia Ken (1971)	Amagasaki City Tsukaguchi Southern Area Redevelopment Project (1978)				Shirokane 1-chome East Area Redevelopment Project (2005)	Shirokane 1-chome East (North Area) Redevelopment Project		
HEALTHCARE		Nippon Cultural Broadcasting Hall (1971)			Kawasaki Medical School Hospital (1971)			Okinawa Prefectural Nanbu Hospital (1979)				Ota General Hospital (1986)	Founder Fuminaga Kiyota strived to make healthcare one of the company's pillars as well as airports, and cultivated his knowledge and expertise.		Urayasu City Health Center (1999)	Tsuchiura Kyodo General Hospital (2016)
WORKPLACE				Tosu City Office (1966)			Yokohama Gokanda Building (1973)				Shizuoka Prefectural Office Annex Building (1996)	Yamashiro City Government Office (2008)		We are currently developing our architectural activities in a variety of areas both domestically and overseas. We have grown to become No. 1 in Japan for airport and sport facility design.		
LOGISTICS & BASIC INFRASTRUCTURE		NICHIREI Kizu Factory (1964)	TOKYO DANCHIREIZO Refrigerated Warehouses (1969)			TOKYO SUISAN TERMINAL Refrigerated Warehouse (1976)	CHUOREITO Isehara Refrigerated Warehouse (1980)				Cut Meat Distribution Center of JMTC (1994)	Yokohama Sunagashima Logistics Center (2003)	ASTEM MinamiKyushu LIS Center (2014)	Yokohama Haneda Logistics Center (2018)		

End of WWII
 Founding of Azusa Architects Office as a limited partnership company, headquartered at Mr. Kiyota's home in Nishino Ward, Tokyo
 Establishment of a Chugoku branch in Okayama City
 Moved to Ginza 7-chome
 Conversion from a limited partnership company to a joint-stock company
 Moved to Marunouchi Takko Building
 10 years since foundation
 Chugoku Branch renamed Okayama Office
 Publication of Azusa Architects Office News
 Establishment of Design Department
 1964 Tokyo Olympics held
 Design Department moved to Onoda Cement Central Research Building
 20 years since foundation
 Establishment of Osaka Office, and Planning Department
 Establishment of Airport Branch Office in Tokyo
 Office moved to Sano Grand Building
 Establishment of Construction Department
 Okayama Office renamed Chugoku Office
 Establishment of Nagoya Office, development of semisoft systems
 Moved headquarters to Gotanda, Shinagawa Ward
 Company renamed Azusa Sekkei Co., Ltd.
 30 years since foundation
 Changed Osaka Office and Fukuoka Office to Branch Offices
 Fuminaga Kiyota awarded the Medal with Yellow Ribbon
 Establishment of Overseas Division (presently International Division)
 Establishment of Shikoku Office in Takamatsu
 First Kiyota Award
 Fuminaga Kiyota passed away; Masao Koda inaugurated as President
 Establishment of Tohoku Office of Computerization Department
 Introduction of Informatics
 Tamura inaugurated as President
 Introduction of general-purpose computer
 Abolishment of Design Department and adoption of three Design Offices
 Ichiro Haruyama inaugurated as President
 First issue of internal newsletter "Azusa" published
 Employee stock ownership association
 Introduction of ranking system for ability
 Sochi Kikumura inaugurated as President
 Implementation of President's Award
 Hiroshi Mori inaugurated as President
 Haneda Airport Branch Office renamed Haneda Airport Project Department
 Decentralized headquarters in Gotanda integrated to Mitsu Seimei Building
 Establishment of Kansai Headquarters
 Kozo Kato inaugurated as President
 50 years since foundation
 Establishment of company website
 Obtained ISO 14001
 Obtained ISO 9001
 Ichiro Imai inaugurated as President
 Establishment of Kyushu Branch Office
 Adoption of executive officer system
 Headquarters moved to Tennozu
 60 years since foundation
 Fumihiko Sugitani inaugurated as President
 Establishment of Environmental Solution Department
 Establishment of Ha Noi Office, Vietnam
 Introduction of studio system
 Revision of CI design
 Great East Japan Earthquake
 Recovery Support Division
 Establishment of Beijing Office, China
 Establishment of Yokohama and Okinawa Offices
 Began Myanmar Azusa
 Absorption merger of M.C. Architects Co., Ltd.
 Establishment of Airport Solution Department
 Execution of local subsidiary in Vietnam
 Formulation of Strategic Cooperation Letter of Intent with China Architecture and Design Institute Ltd.
 Formulation of new brand slogan, "Architectural Design with Passion"
 Complete revision of company website
 Establishment of Hokkaido Office
 Tokyo 2020 Olympic and Paralympic Games

TRANSPORT INFRASTRUCTURE DOMAIN

Tokyo International Airport International Passenger Terminal Building

Location: Ota Ward, Tokyo
Completion: July 2010
Floors: 5F
Total floor area: 236,555m²

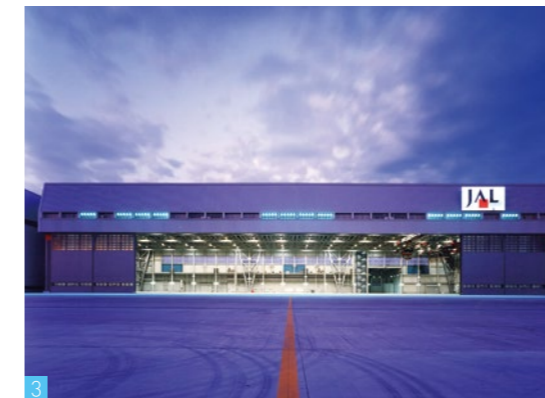

Leveraging skills accumulated through airport design

Azusa Sekkei has a long history of designing Japanese airport facilities. In our Transport Infrastructure Domain, we highly leverage our design know-how in the airport sector to further extend our design services into the port, rail, and land transport sectors as well, in both Japan and throughout the world. Aiming at expanding our design services to the development of surrounding regions of such transport infrastructure, we will continue to strengthen collaboration with both in-house and external specialists in sectors such as development and commercial facilities.

1 Tokyo International Airport West Passenger Terminal Building

Location: Ota Ward, Tokyo
Completion: July 1993
Floors: 6F/B1
Total floor area: 291,493m²

2 Narita International Airport Terminal 1 Building

Location: Narita City, Chiba
Completion: June 2006
Floors: 7F/B2
Total floor area: 451,000m²

3 Japan Airlines Haneda Airport Hangar

Location: Ota Ward, Tokyo
Completion: 1993
Capacity: 2 large aircraft and 1 mid-sized aircraft
Total floor area: 24,888m²

4 ANA Tokyo Haneda Airport Tokyo New No.2 Hangar

Location: Ota Ward, Tokyo
Completion: May 2009
Capacity: 3 large aircraft
Total floor area: 22,825 m²

5 Shinko Cruise Terminal

Location: Yokohama City, Kanagawa
Completion: November 2019*
Floors: 5F
Total floor area: 28,677m²

6 JR Shin-Takaoka Station

Location: Takaoka City, Toyama
Completion: August 2014
Floors: 2F
Total floor area: 2,467m²

TOPICS

Domestic airport share

75%

*based on amount of users

SPORTS·ENTERTAINMENT DOMAIN

New National Stadium Development Project

Location: Shinjuku Ward, Tokyo
Completion: November 2019*
Floors: 5F/B2
Total floor area: 194,000 m²

* Expected completion



This perspective drawing and other drawings are images based on projections of the completed building and may differ from the actual building. The projected time period is about 10 years after planting of greenery has been completed.
 © Taisei Corporation, Azusa Sekkei Co., Ltd., and Kengo Kuma and Associates Joint Venture



Leading Japan's sports and entertainment culture

Future stadiums and arenas have become essential for national economic growth and regional revitalization, as facilities that provide the trigger for regional development and form the core of regional economies.

Working toward the creation of stadiums and arenas that capitalize on the inherent diversity of sports and generate various elements of added value, Azusa Sekkei provides total management in building such facilities, in consideration of daily operations.

1 Kitakyushu Stadium (Mikuni World Stadium Kitakyushu)

Location: Kitakyushu City, Fukuoka
Completion: January 2017
Floors: 6F
Total floor area: 26,398m²

2 Yokohama Cultural Gymnasium Redevelopment Project

Location: Yokohama City, Kanagawa
Completion: March 2024*
Floors: main 3F, sub 4F
Total floor area: main 15,500m², sub 14,500m²

3 Matsuyama Central Park Swimming Pool (Aqua Palette Matsuyama)

Location: Matsuyama City, Ehime
Completion: May 2005
Floors: 2F/B1
Total floor area: 7,999m²

4 Inuyama Gymnasium

Location: Inuyama City, Aichi
Completion: April 2016
Floors: 2F
Total floor area: 6,573m²

5 Tochigi General Sports Zone

Location: Utsunomiya City, Tochigi
Completion: January 2021*
Floors: 4F
Total floor area: 38,554m²

6 K Arena Project (tentative name)

Location: Yokohama City, Kanagawa
Completion: September 2022*
Floors: arena 5F, hotel 21F, office building 20F, exhibition hall 1F
Total floor area: 102,000m²

TOPICS

Design achievements for sport facilities

No.1

*Ranking of architectural offices (FY2018)

URBAN DEVELOPMENT / COMMERCIAL FACILITIES DOMAIN

Shirokane 1-chome East Area Redevelopment Project

Location: Minato Ward, Tokyo
Completion: November 2005
Floors: 42F/B3
Total floor area: 136,232 m²

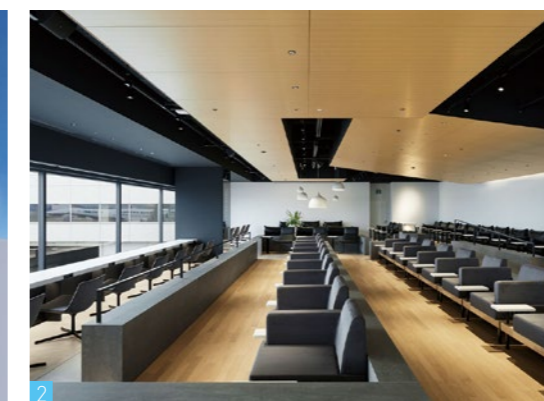

A leader in urban and architectural innovation

In urban design, we find the architectural format most appropriate for the urban environment and pursue the ideal shapes for lifestyles and communication. In commercial facility design, we aim to create comfortable spaces where the people who visit can always feel like the focus is on them. Using our wide range of experience and highly specialized knowledge and skills, we enhance the value of the land or place, and propose a plan that increases the value and brand equity of the project.

1 Shirokane 1-chome East (North Area) Redevelopment Project

Location: Minato Ward, Tokyo
Completion: 2022*
Floors: 45F/B1
Total floor area: 134,600 m²

2 Tokyo International Airport Domestic Lounge (Power Lounge)

Location: Ota Ward, Tokyo
Completion: April 2017
Total floor area:
south 569.17 m²,
north 650.52 m²

3 Daiwa Royal Ariake South (tentative name)

Location: Koto Ward, Tokyo
Completion: September 2018
Floors: 17F/B1
Total floor area: 21,760 m²

4 Ofuna Station North (Area No. 2) Redevelopment Project

Location:
Yokohama City, Kanagawa
Completion: December 2020*
Floors: 21F/B2
Total floor area: 65,656 m²

5 Regina Resort Kyu Karuizawa

Location:
Karuizawa Town, Nagano
Completion: October 2017
Floors: 2F
Total floor area: 2,571 m²

6 Kumamoto Shimotori Shintengai Shopping Arcade NS Building (COCOSA)

Location:
Kumamoto City, Kumamoto
Completion: March 2017
Floors: 8F/B1
Total floor area: 18,675 m²

HEALTHCARE DOMAIN

Tsuchiura Kyodo General Hospital

Location: Tsuchiura City, Ibaraki
 Completion: October 2015
 Floors: 10F/800 beds
 Total floor area: 78,895 m²

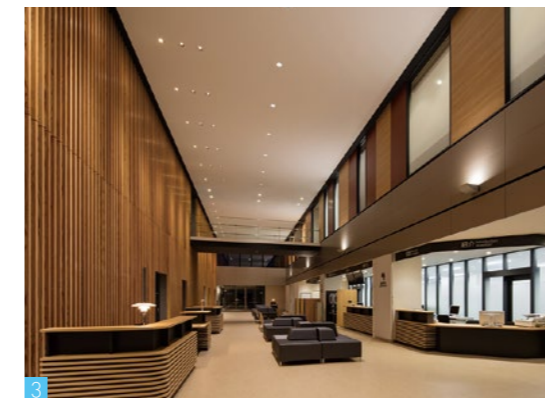

Design for various spaces

In our Healthcare Domain, we are involved in domestic and international project in the areas of welfare, health, and medical care, based on our basic policy that any design should faithfully live up to the expectations of the client.

In Japan, we cover the range from the creation of the space which makes patient comfortable and at home, to state-of-the-art facilities for radiation therapy. Our overseas projects cover the range from public health centers supporting Basic Human Needs* to highly advanced hospitals that enable patients to be treated in their own countries.

In order to respond to wide and various demand, we accumulate advanced technologies and improve our skills through our practice.

*Basic Human Needs (BHN) refers to the minimum and most basic necessities for human life.

1 Chubu Tokushukai Hospital

Location: Nakagami District, Okinawa
 Completion: February 2016
 Floors: 12F/331 beds
 Total floor area: 53,314 m²

2 Shinagawa Rehabilitation Park and Shinagawa Ward Osaki Library

Location: Shinagawa Ward, Tokyo
 Completion: March 2018
 Floors: 8F/B1
 Total floor area: 11,581 m²

3 Karatsu Red Cross Hospital

Location: Karatsu City, Saga
 Completion: April 2016
 Floors: 7F/304 beds
 Total floor area: 24,676 m²

4 Fujita Health University Hospital new building

Location: Toyoake City, Aichi
 Completion: April 2015
 Floors: 13F/B1/741 beds
 Total floor area: 56,097 m²

5 Fukuoka Saiseikai Iizuka Kaho Hospital

Location: Iizuka City, Fukuoka
 Completion: March 2011
 Floors: 7F/199 beds
 Total floor area: 14,958 m²

6 Itami Gardens Clinic

Location: Itami City, Hyogo
 Completion: March 2016
 Floors: 2F/46 beds
 Total floor area: 2,290 m²

TOPICS

Design achievements for healthcare facilities

No.3

*Ranking of architectural design offices [FY2018]

WORKPLACE DOMAIN

Kyosan Electric Manufacturing Head Office and Factory Building

Location: Yokohama City, Kanagawa
 Completion: May 2017
 Floors: 3F
 Total floor area: 4,317 m²

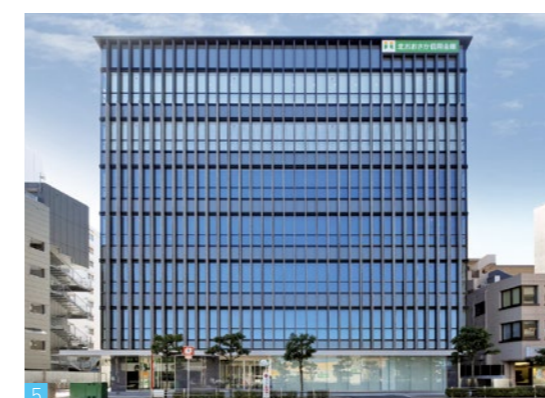

Creating the future of government/office buildings

The functions and features required by government and office buildings are various and complicated. In our Workplace Domain, we work together with clients to find optimal solutions, responding to the constantly changing needs and systems of society, such as government initiatives for better work-life balance and the introduction of the individual social security and tax number system. By developing our human resources and sharing the technologies and information of facilities such as government and office buildings, Azusa strives for constant improvement in our competitiveness and capacity for proposals, thus allowing us to provide superior services to clients from both the public and private sectors. Creating facilities that support people's lives, we aim to contribute to the sustainable economic growth of cities and the nation.

1 Ono Pharmaceutical Tokyo Building
 Location: Chuo Ward, Tokyo
 Completion: March 2018
 Floors: 10F/B1
 Total floor area: 9,481 m²

2 Tsubame City Government Office
 Location: Tsubame City, Niigata
 Completion: March 2013
 Floors: 4F
 Total floor area: 13,109 m²

3 Koka City Government Office
 Location: Koka City, Shiga
 Completion: January 2018
 Floors: 6F
 Total floor area: 16,758 m²

4 Fujisawa City New Government Office
 Location: Fujisawa City, Kanagawa
 Completion: December 2017
 Floors: 10F/B1
 Total floor area: 35,435 m²

5 Kita Osaka Shinkin Bank
 Location: Ibaraki City, Osaka
 Completion: February 2016
 Floors: 7F
 Total floor area: 9,020 m²

6 Kobayashi City Government Office
 Location: Kobayashi City, Miyazaki
 Completion: March 2018
 Floors: 4F
 Total floor area: 7,197 m²

TOPICS

Design achievements

in **40** PREFECTURES

LOGISTICS & BASIC INFRASTRUCTURE DOMAIN

Yokorei Meiko Distribution Center
 Location: Nagoya City, Aichi
 Completion: November 2018
 Floors: 5F
 Total floor area: 20,754 m²

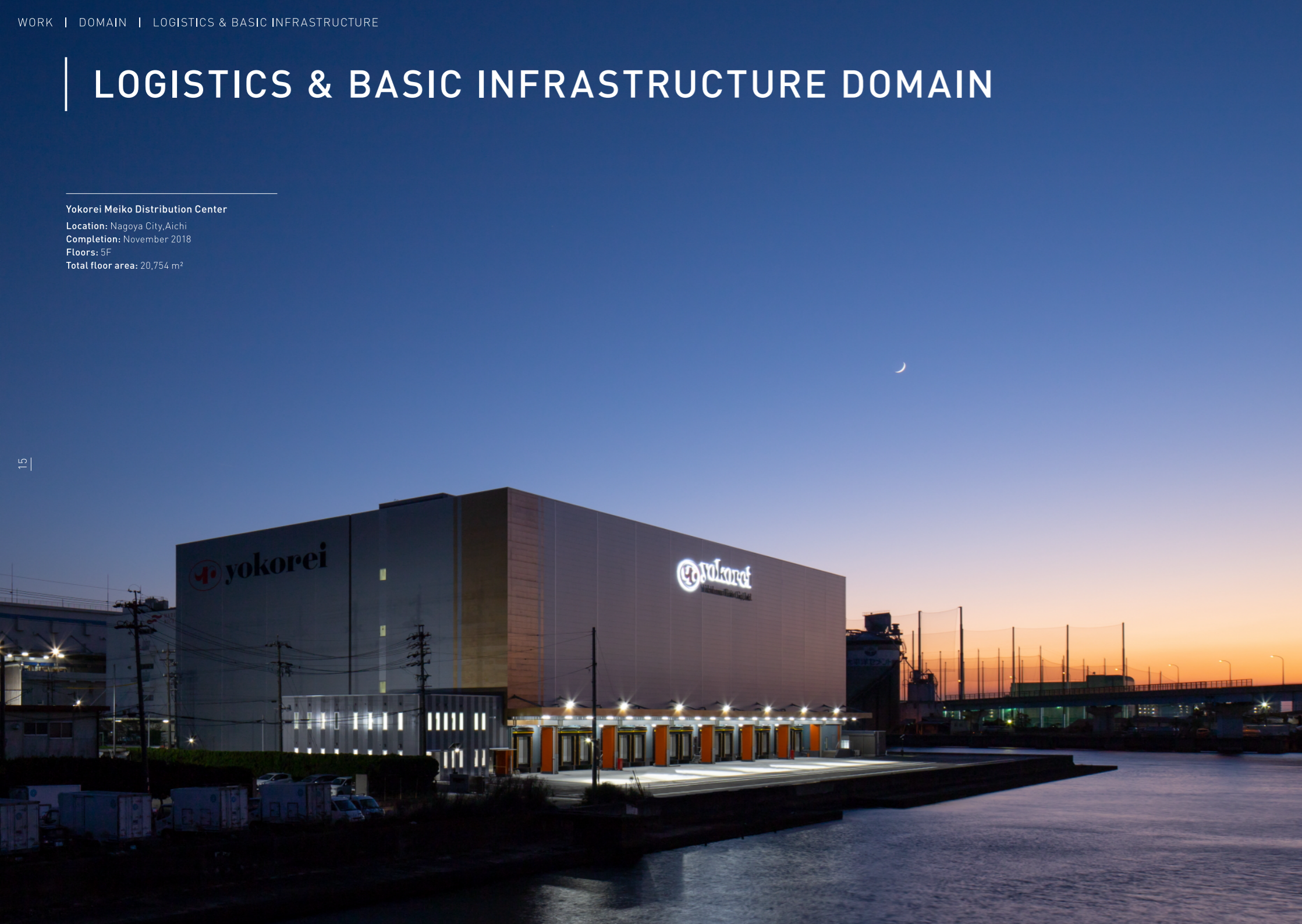

Build the diversity social demand based on experience and quality

Architectural design and value are evolving as demands from systems, programs, software, etc. increase in diversifying lifestyles. Life infrastructure which can be said to be social infrastructure, should be able to follow the changes over a long period of time even after starting operation as a building. We will respond the diversity social demand with our information and overall capabilities based on the long-term experiences and quality as an Organization Architectural Design Firm.

1 Yokorei Tokyo Haneda Distribution Center
 Location: Ota Ward, Tokyo
 Completion: February 2018
 Floors: 3F
 Total floor area: 16,876 m²

2 Okayama City Higashiyama Funeral Hall
 Location: Okayama City, Okayama
 Completion: March 2019
 Floors: 3F/B1F/16furnaces
 Total floor area: 5,280 m²

3 OCS Base International Distribution Center
 Location: Koto Ward, Tokyo
 Completion: August 2017
 Capacity: 8F
 Total floor area: 19,900 m²

4 Fukuyama Transporting Tokyo Branch Office
 Location: Koto Ward, Tokyo
 Completion: December 2016
 Capacity: 7F
 Total floor area: 101,729 m²

5 ASTEM Kirishima LIS Center
 Location: Kirishima City, Kagoshima
 Completion: October 2014
 Floors: 3F
 Total floor area: 15,371 m²

6 Saku City Funeral Hall
 Location: Saku City, Nagano
 Completion: March 2016
 Floors: 2F/7furnaces
 Total floor area: 3,886 m²

TOPICS

Design achievements for logistics facilities

No.2

*Ranking of architectural design offices [FY2018]

OTHER WORKS

Educational & Research Facilities

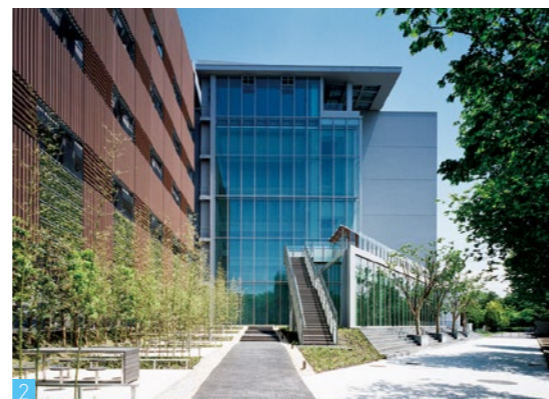

1 Tsukubamirai Municipal Yokodai Elementary School
 Location: Tsukubamirai City, Ibaraki
 Completion: May 2015
 Floors: 2F
 Total floor area: 10,895 m²

2 National Institute for Materials Science General Research Building
 Location: Tsukuba City, Ibaraki
 Completion: March 2012
 Floors: 6F
 Total floor area: 14,776 m²

3 Notre Dame Jogakuin, Kitayama Campus, Kyoto Notre Dame University
 Location: Kyoto City, Kyoto
 Completion: May 2015
 Floors: 4F/B1
 Total floor area: 9,703 m²

4 Yamazaki Baking Company's Creation Center
 Location: Ichikawa City, Chiba
 Completion: October 2016
 Floors: 7F/B2
 Total floor area: 18,657 m²

5 Tokai Village Nakamaru Elementary School
 Location: Tokai Village, Naka District, Ibaraki
 Completion: June 2016
 Floors: 3F
 Total floor area: 7,350 m²

6 Raito Kogyo Tsukuba R&D Center
 Location: Tsubuka City, Ibaraki
 Completion: December 2017
 Floors: 2F
 Total floor area: 3,285 m²

Cultural Facilities

1 TOTO Museum
 Location: Kitakyushu City, Fukuoka
 Completion: May 2015
 Floors: 4F
 Total floor area: 10,797 m²

2 Kitsuki City Library
 Location: Kitsuki City, Oita
 Completion: February 2018
 Floors: 2F
 Total floor area: 2,100 m²

3 Yui no Mori Arakawa
 Location: Arakawa Ward, Tokyo
 Completion: January 2017
 Floors: 5F/B1
 Total floor area: 10,943 m²

4 Echigo Tsumari Cultural Hall and Tokamachi Central Community Center (Danjuro)
 Location: Tokamachi City, Niigata
 Completion: September 2017
 Floors: 4F
 Total floor area: 5,258 m²

5 Yamanashi Prefectural Museum
 Location: Fuefuki City, Yamanashi
 Completion: February 2005
 Floors: 1F
 Total floor area: 8,760 m²

6 Gifu-Kakamigahara Air and Space Museum
 Location: Kakamigahara City, Gifu
 Completion: November 2017
 Floors: 2F
 Total floor area: 12,320 m²

TOPICS

No. of TOTO Museum visitors

200,000

*A little over two years since opening

No. of Yui no Mori Arakawa visitors

500,000

*In the first 9-month period in the first year

OTHER WORKS

Overseas Projects



Private Finance Initiative Project

Based on our numerous achievements as a player in the PFI market, Azusa Sekkei will continue to respond to the needs of our clients. Amidst the introduction and utilization of various project ordering systems, it is foreseen that DB/PFI/PPP concessions will further increase in the future. Using our human resources with extensive specialized knowledge, as well as our collective expertise, these projects can be carried out successfully, as we strengthen our organization to drive steady project implementation.

TOPICS

Execution of overseas projects

More than
30
COUNTRIES

1 New Ulaanbaatar International Airport Passenger Terminal

Location: Mongolia
Completion: January 2017
Floors: 4F
Total floor area: 33,300 m²

2 Laos Wattay International Airport Expansion

Location: Laos
Completion: August 2018
Floors: 4F
Total floor area: 24,000 m²

3 Taoyuan City Main Public Library Complex

Location: Taiwan
Completion: June 2021*
Floors: 8F/B2
Total floor area: 52,000 m²

4 Kien Giang Province General Hospital

Location: Vietnam
Completion: 2020*
Floors: 9F/1,020 beds
Total floor area: 103,418 m²

5 Hanoi Software Technology Park

Location: Vietnam
Completion: TBD*
Floors: 33F/B2
Total floor area: 840,000 m²
(Basic design)

6 Japan-Laos Budokan

Location: Myanmar
Completion: October 2009
Floors: 3F
Total floor area: 1,796 m²

TOPICS

No. of PFI business initiatives handled

More than
70
PROJECTS

1 Kamisu Central Park Disaster Prevention Arena (tentative name) Facility and Management Project

Location: Kamisu City, Ibaraki
Completion: March 2019*
Floors: 2F
Total floor area: 18,574 m²

2 New Hachioji City Gymnasium etc., Facility and Management Project

Location: Hachioji City, Tokyo
Completion: July 2014
Floors: 4F
Total floor area: 23,092 m²

3 Chugoku Local Finance Bureau / Government Workers Apartment Asuta Homes Project

Location: Hiroshima City, Hiroshima
Completion: June 2011
Floors: 14F
Total floor area: 41,464 m²

4 Otsu City Lake Biwa Joint Government Building Project

Location: Otsu City, Shiga
Completion: October 2011
Floors: 10F/B1
Total floor area: 19,500 m²

5 Shimonoseki Budokan Project

Location: Shimonoseki City, Yamaguchi
Completion: June 2011
Floors: 2F
Total floor area: 10,923 m²

6 Tokyo District and Family Court / Tachikawa Branch Official Residence

Location: Tachikawa City, Tokyo
Completion: March 2009
Floors: 8F/B1
Total floor area: 27,135 m²

www.azusasekai.co.jp/en/



Azusa Sekkei Co., Ltd.

3F, MFIP Haneda, 10-11, Haneda Asahi-cho, Ohta-ku, Tokyo, 144-0042, Japan tel:+81-3-5735-3210

Copyright© Feb. 2020 Azusa Sekkei Co., Ltd.